

THIS DRAWING IS UNPUBLISHED. RELEASED FOR PUBLICATION
 © COPYRIGHT BY TYCO ELECTRONICS CORPORATION. ALL RIGHTS RESERVED.

LOC		DIST		REVISIONS			
P	LTR	DESCRIPTION		DATE	DWN	APVD	
	D	ECO-07-012862		12JUN07	KW	DB	

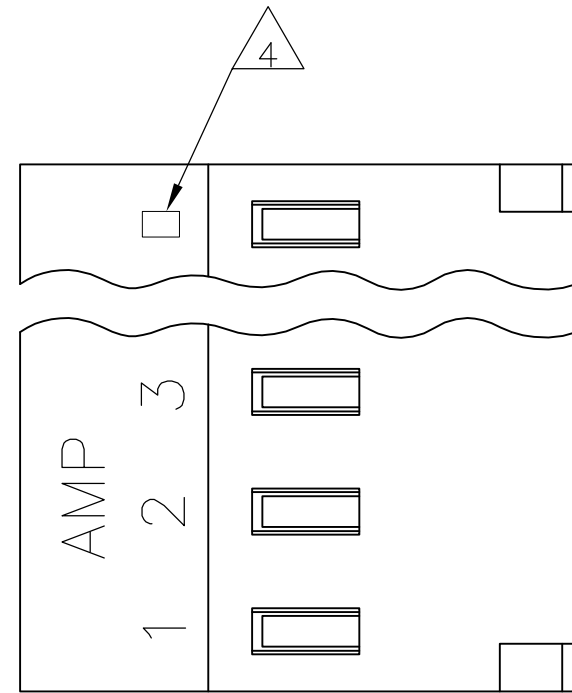

- 1 MATERIAL: CONNECTOR - NYLON UL94V-2 (WHITE).
CONTACTS - 0.30 [.012] THICK COPPER ALLOY BRIGHT-TIN LEAD 0.00203 [.000080] MIN THICK FOR CONTACTS 644464-2 THRU 1-644464-4 MATTE WHISKER MITIGATED TIN 0.00203 [.000080] MIN THICKNESS OVER NICKEL UNDERPLATE FOR 3-644464-2 THRU 4-644464-4
- 2. CONTACTS ACCEPT 24 AWG WIRE WITH 2.41[.095] MAX INSULATION DIAMETER.
- 3. CONTACTS MUST ACCEPT 1.14±0.03 [.045±.001] POST AND REMAIN LOCKED IN POSITION.
- 4 IDENTIFICATION NUMBER FOR LAST CIRCUIT MAY NOT APPEAR ON ALL ASSEMBLIES.
- 5. DIMENSIONS IN BRACKETS ARE IN INCHES.
- 6. HOUSING FEATURES ARE: CLOSED END WITHOUT LOCKING RAMP AND WITH POLARIZING TAB.

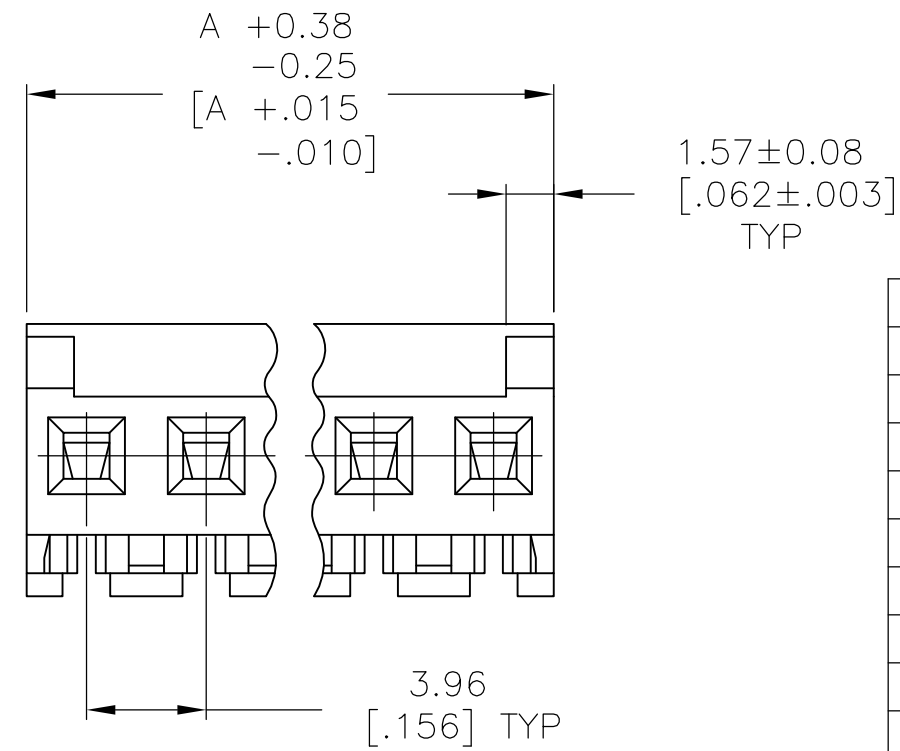
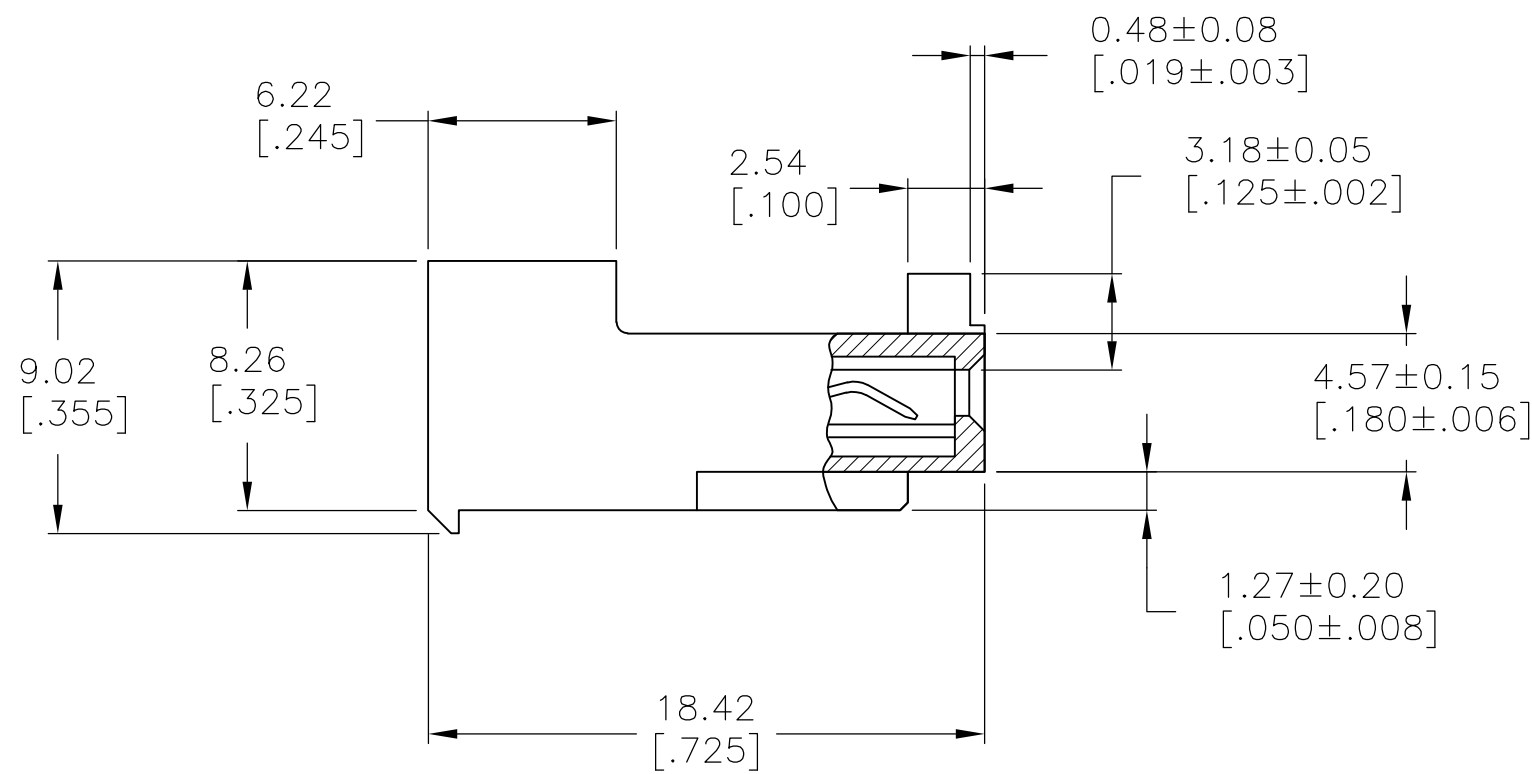

TIN	55.47	[2.184]	14	4-644464-4
TIN	51.51	[2.028]	13	4-644464-3
TIN	47.55	[1.872]	12	4-644464-2
TIN	43.59	[1.716]	11	4-644464-1
TIN	39.62	[1.560]	10	4-644464-0
TIN	35.66	[1.404]	9	3-644464-9
TIN	31.70	[1.248]	8	3-644464-8
TIN	27.74	[1.092]	7	3-644464-7
TIN	23.77	[.936]	6	3-644464-6
TIN	19.81	[.780]	5	3-644464-5
TIN	15.85	[.624]	4	3-644464-4
TIN	11.89	[.468]	3	3-644464-3
TIN	7.92	[.312]	2	3-644464-2
TIN-LEAD	55.47	[2.184]	14	1-644464-4
TIN-LEAD	51.51	[2.028]	13	1-644464-3
TIN-LEAD	47.55	[1.872]	12	1-644464-2
TIN-LEAD	43.59	[1.716]	11	1-644464-1
TIN-LEAD	39.62	[1.560]	10	1-644464-0
TIN-LEAD	35.66	[1.404]	9	644464-9
TIN-LEAD	31.70	[1.248]	8	644464-8
TIN-LEAD	27.74	[1.092]	7	644464-7
TIN-LEAD	23.77	[.936]	6	644464-6
TIN-LEAD	19.81	[.780]	5	644464-5
TIN-LEAD	15.85	[.624]	4	644464-4
TIN-LEAD	11.89	[.468]	3	644464-3
TIN-LEAD	7.92	[.312]	2	644464-2
FINISH	DIM A		NO OF CIRCUITS	PART NO

644464

B

A

THIS DRAWING IS A CONTROLLED DOCUMENT.

DIMENSIONS: mm [INCHES]	TOLERANCES UNLESS OTHERWISE SPECIFIED: 0 PLC ± - 1 PLC ± - 2 PLC ± - 3 PLC ± 0.13 [.005] 4 PLC ± - ANGLES ± -	DWN B. LEWIS 12 FEB 91 CHK R. SWING 12 FEB 91 APVD D. CLARK 20 FEB 91	Tyco Electronics Corporation Harrisburg, Pa 17105-3608
		PRODUCT SPEC 108-1051 APPLICATION SPEC 114-1020	NAME MTA-156 CONNECTOR ASSEMBLY, 24 AWG, STANDARD
MATERIAL 1	FINISH 1	WEIGHT -	SIZE A2 CAGE CODE 00779 DRAWING NO C=644464 RESTRICTED TO -
CUSTOMER DRAWING			SCALE 4:1 SHEET 1 OF 1 REV D

